

The multitallented – self-centring vice

centros²

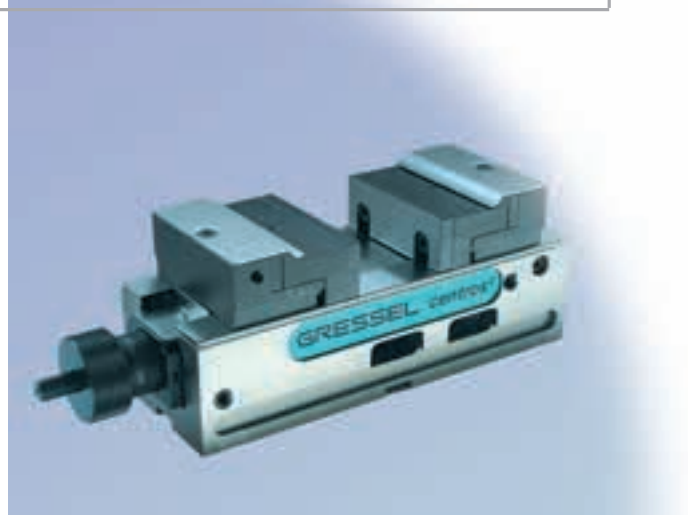

One clamping device for almost all work pieces

Whether it is conventional clamping, small contact area 5-sided machining, pre-machined, cast, saw cut blanks, plates or any other workpiece, centros² allows you to quickly adjust the clamping to hold your part.

The difference lies in the details

In addition to convenience and precision, centros² also offers a sophisticated and ingenious system with interchangeable jaw sets. Standard jaws with integrated «pull-down» effect simply «click-into» position with no need for screws.

Modular design

The refined and future-orientated design of centros² allows combinations of high jaws for 5-axis machines, a new revolving jaw or a universal plate to be used at any time.

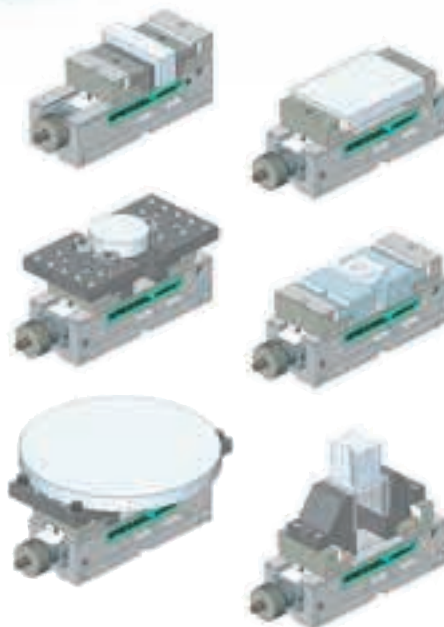

centros² Self-centring & simple clamping

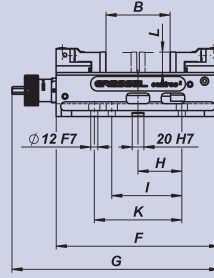
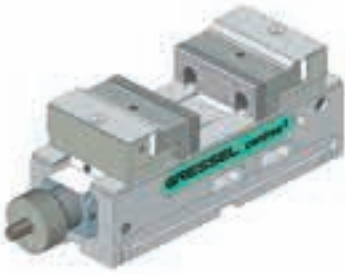

Self-centring vice

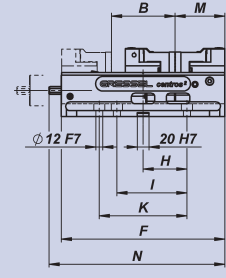

Standard clamping vice

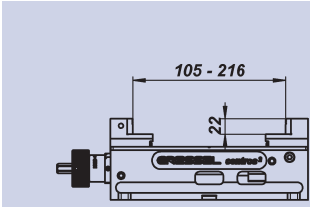
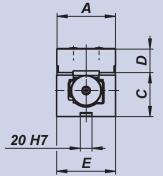

in VS-Version (Standard)

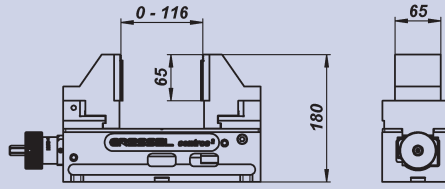

with 5A basic jaws

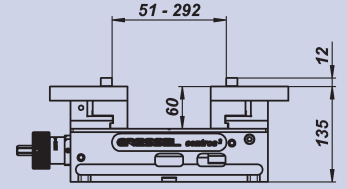

with universal adapter plate

Type	Dimensions [mm]												
	A	B	C	D	E	F	G	H	I	K	L	M	N
centros ² 100	100	0-110	75	40	101	280	356	75	120	150	35	85,2	301-356

Type	Description	Jaw width [mm]	Clamp. force [kN]	Weight [kg]	Order no.
centros ² 100	Self-centring vice	100	25	16,2	CSM.100.000.01

Scope of delivery: centros² incl. 2 basic jaws and profiled jaws, 2 jaws grip 100 x 22 reversible, covers, 4 straps



Differential screw
for direct clamping of un-machined parts can be used with reversible jaw in 5 positions

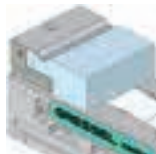

Aluminium interchangeable false jaw
Aluminium blank jaws for shaped or machine parts with integrated pull-down effect



Universal adapter plate
with 10 M12 tapped holes for taking up standard clamping elements



VS version for extended clamping width with grip jaw
reversible, smooth and with grip profile, for narrow clamping of work-pieces (standard)



Basic jaws
Self-positioning and centring without any tedious screwing. With integrated pull-down effect

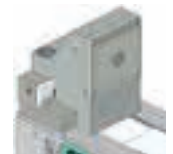

5A basic jaw
with new revolving jaw and 4 options to allow fast change-overs from first to second operations



Blank jaw
for holding shaped parts, used with the differential clamping screws for 3 or 4 point clamping

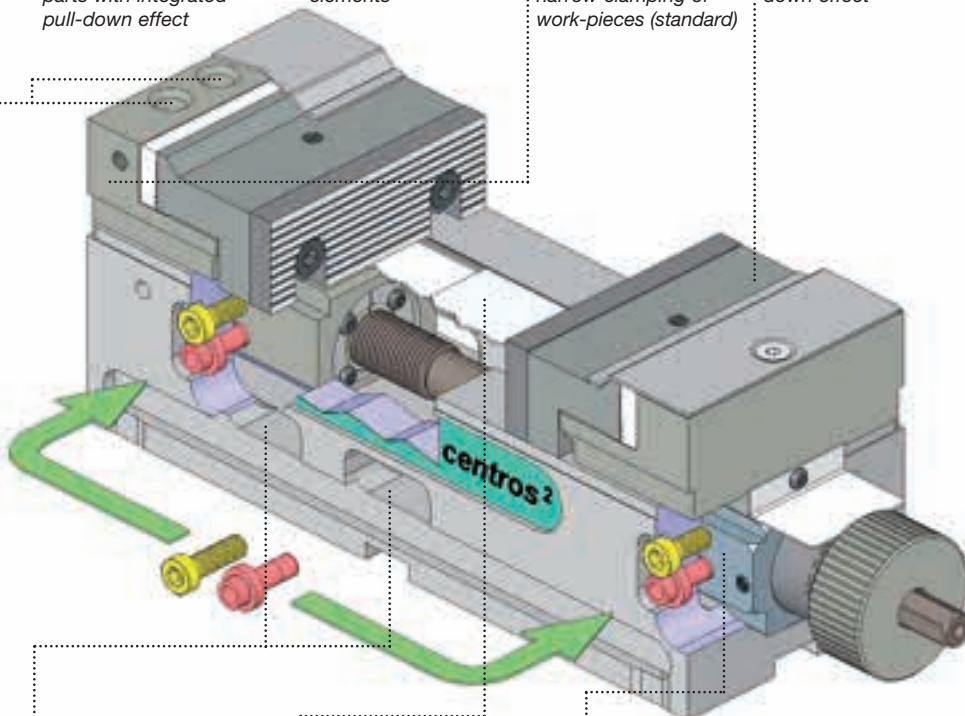

Work-piece supports
New design permits direct installation on the body and basic jaw



5-fold reversing jaw with 5 clamping zones, profiled, milled, with grip profile, roughened surface and a clamping tip

Coolant drain
allows coolant and debris to escape in both standard and self centring operation

Covers
Optimum protection against chips in all positions

Self-centring unit
for conversion from a self-centring to a simple clamping device. Quick dismantling for cleaning

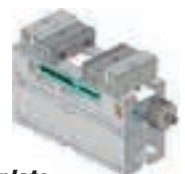

Riser plate
allows an increase in height of the vice upto 195mm etc.

centros² Universal adapter plate

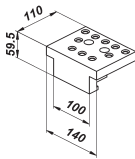

Type	Description	Order no.
Universal adapter plate	Adapter plates for centros ² (2 pieces)	CSA.100.004.01
	Adapter plates with 10 M12 tapped holes for use with standard clamping elements, differential screws, Reversible jaws and other clamping elements. Simple and fast mounting with pre-clamping and clearance compensation.	

centros² 5-fold reversing jaw with 5 clamping zones

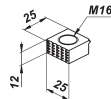

Type	Description	Order no.
Reversing jaw	Reversing jaw with 5 clamping zones	CSA.100.006.11
	Five clamping zones in one element permit flexible use. 1. N6 clamping surface milled smooth for gentle clamping. 2. Profiled clamping surface. 3. Smooth with coated surface for increased hold for machined work-pieces. 4. Pyramid-profile for strong grip for unmachined parts. 5. Clamping tip with reference stop for unmachined work-pieces.	

Scope of delivery: without differential clamping screw

centros² Differential screw

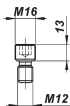

Type	Description	Order no.
Differential screw	for direct clamping of unmachined parts and use with 5-fold reversing jaw.	CSA.100.005.11

centros² Blank jaw

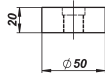

Type	Description	Order no.
Blank Jaw	Material: 14NiCr14	CSA.100.012.11
	For clamping of shaped parts for use with differential clamping screws as three or four point clamping. The jaws can be shaped individually to requirements and can be hardened.	

centros² Aluminium quick-change jaws

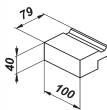

Type	Description	Order no.
ALU quick-change jaws	Aluminium quick-change jaws for shaped parts (2 pieces)	CSA.100.007.01
	Quick-change jaw for shaped parts with integrated pull-down effect. Self-positioning and centring without any tedious screwing down. No disturbing screws in order to ensure a maximum clamping surface.	

centros² 5A basic jaw

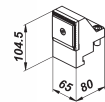

Type	Description	Order no.
5A basic jaw	5-axis basic jaws 65 (2 pieces) with revolving jaws	CSA.100.001.01
	Jaw width of 65mm and clamping height of 180mm provide optimum access from all 5 sides for small and medium-sized work-pieces. Novel revolving jaw with 4 options allows clamping into four different clamping zones and fast conversion from first to second clamping. Grip profile 3mm, grip profile 5mm, grip profile 8mm and smooth jaw with coated surface for increased friction.	

centros² Riser plate

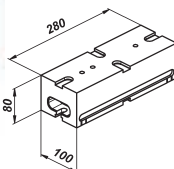

Type	Description	Order no.
Riser plate	for centros ² incl. fittings	CSA.100.000.01
	Allows retrofitting to centros ² in order to raise the base body by 80mm to ensure better accessibility.	

Scope of delivery: Riser plate incl. assembly material for the assembly centros²

centros² Work-piece supports

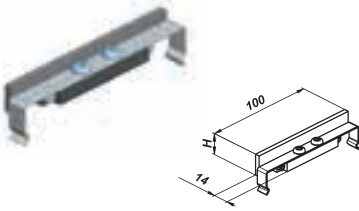

Type	Description		Order no.
Work-piece supports	Set of 2 pieces	H=32,0 (3mm for 35)	CSA.100.032.01
Work-piece supports	Set of 2 pieces	H=30,0 (5mm for 35)	CSA.100.030.01
Work-piece supports	Set of 2 pieces	H=27,0 (8mm for 35)	CSA.100.027.01
Work-piece supports	Set of 2 pieces	H=19,0 (16mm for 35 / 3mm for 22)	CSA.100.019.01
Work-piece supports	Set of 2 pieces	H=17,0 (18mm for 35 / 5mm for 22)	CSA.100.017.01
Work-piece supports	Set of 2 pieces	H=14,0 (21mm for 35 / 8mm for 22)	CSA.100.014.01

centros² Stepped jaw grip

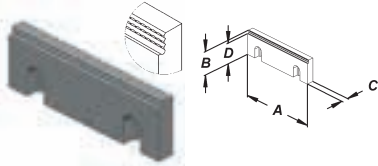

Type	Description	A	B	C	D	Order no.
Stepped jaw grip 3	Set of 2 pieces	100	35	10	32	MSA.100.172.01
Stepped jaw grip 5	Set of 2 pieces	100	35	10	30	MSA.100.171.01
Stepped jaw grip 8	Set of 2 pieces	100	35	10	27	MSA.100.170.01

centros² Torque wrench / Lever



Type	Description	Order no.
Torque wrench	20 – 100Nm with readable dial	XFN.91101.012
Hinged offset lever	incl. hex socket	XFN.91105.012

For secure and reliable clamping of work-pieces.

centros² Clamping set



Type	Description	Order no.
Clamping set	for centros ² for T slot 12mm	CSA.100.112.01
Clamping set	for centros ² for T slot 14mm	CSA.100.114.01
Clamping set	for centros ² for T slot 16mm	CSA.100.116.01
Clamping set	for centros ² for T slot 18mm	CSA.100.118.01

Scope of delivery: 2 screws, 2 washers, 2 T slot nuts, 2 precision slot nuts

centros² Clamping force diagram

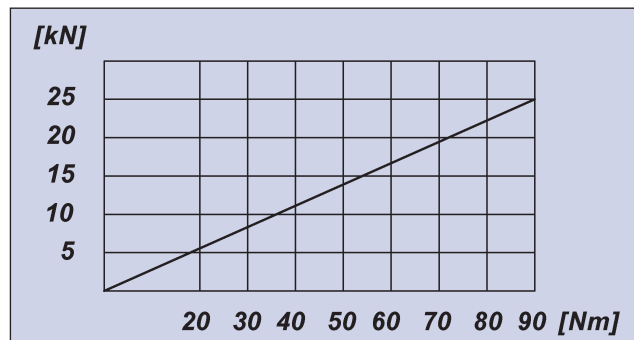

Sales

GRESSEL AG
 Spanntechnik
 Schützenstrasse 25
 CH-8355 Aadorf
 Schweiz
 Tel. +41 (0)52 368 16 16
 Fax +41 (0)52 368 16 17

info@gressel.ch

www.gressel.ch